

# L24

EN 442 & EN 14037 tested

- > Linear T-Bar Radiant Panel
- > Water Based
- > Ceiling Mounted

| DESCRIPTION  | CONSTRUCTION   | FEATURES   |
|--|--|--|
| <p>The L24 is an extruded aluminium radiant heating strip that provides exceptionally high heat transfer. It offers a modular indoor solution that has been designed specifically for T-Bar ceiling integration. Operating with a proven water-based heat exchange system that operates from a boiler.</p> | <p>Extruded aluminium planks, copper tubing with flow &amp; return 15 mm connections and rFoil™ insulation.</p> <p><b>Finish:</b><br/>RAL 9010 polyester powder coating.</p> <p><b>Options:</b></p> <ul style="list-style-type: none"> <li>• anti-bacterial coating</li> <li>• acoustic perforation</li> </ul> | <p>Mean water temp: 45°C to 80°C</p> <p>Coil passes: 4, 6 or 8</p> <p>Max. length: up to 4,800 mm (in one piece)</p> |

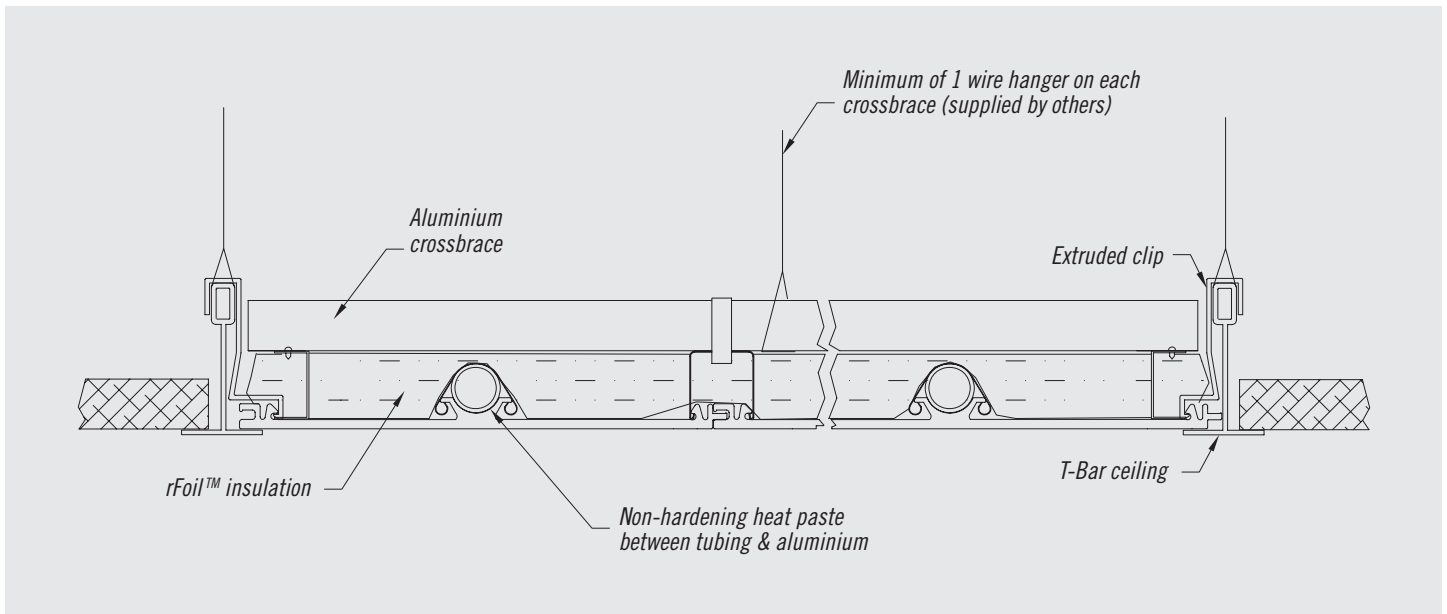

| L24 SELECTION DATA     |        |        |       |       |       |       |       |       |       |       |
|------------------------|--------|--------|-------|-------|-------|-------|-------|-------|-------|-------|
| Mean Water Temperature |        |        |       |       |       |       |       |       |       |       |
|                        |        | Passes | 45 °C | 50 °C | 55 °C | 60 °C | 65 °C | 70 °C | 75 °C | 80 °C |
| Width                  | 600 mm | 4      | 150   | 187   | 201   | 258   | 294   | 336   | 367   | 406   |
|                        |        | 6      | 156   | 195   | 209   | 269   | 308   | 350   | 386   | 427   |
|                        |        | 8      | 163   | 204   | 217   | 281   | 323   | 364   | 406   | 448   |

### KEY INFORMATION

Outputs expressed in watts per linear metre and are based on 21°C room temperature. For every 1°C decrease in temperature below 21°C, the output increases by 2%.